

Oops (sp. 8 mm.)

PROFILI

Vista frontale OOPS di serie Misure in millimetri

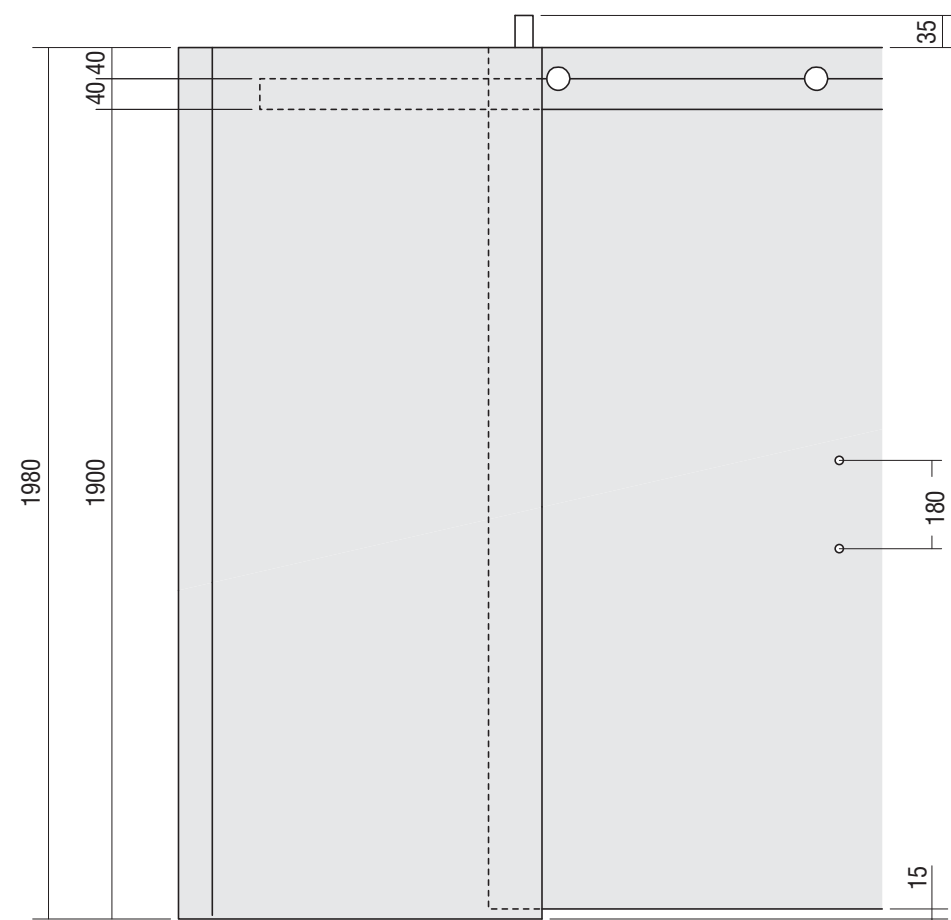

Vista dall'alto PSNI

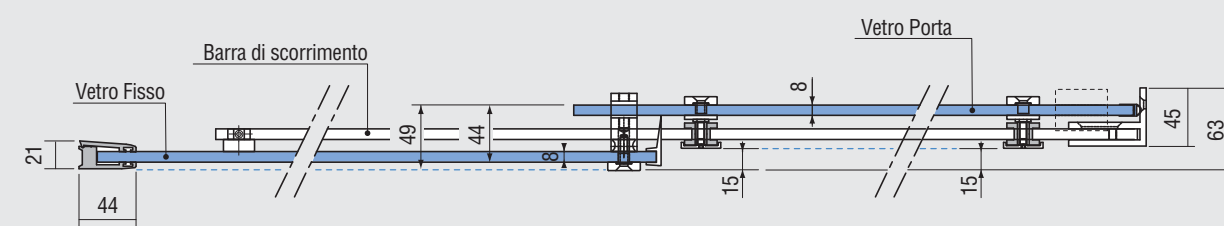

Vista dall'alto PSPO+PSFI

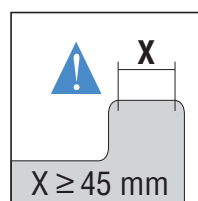
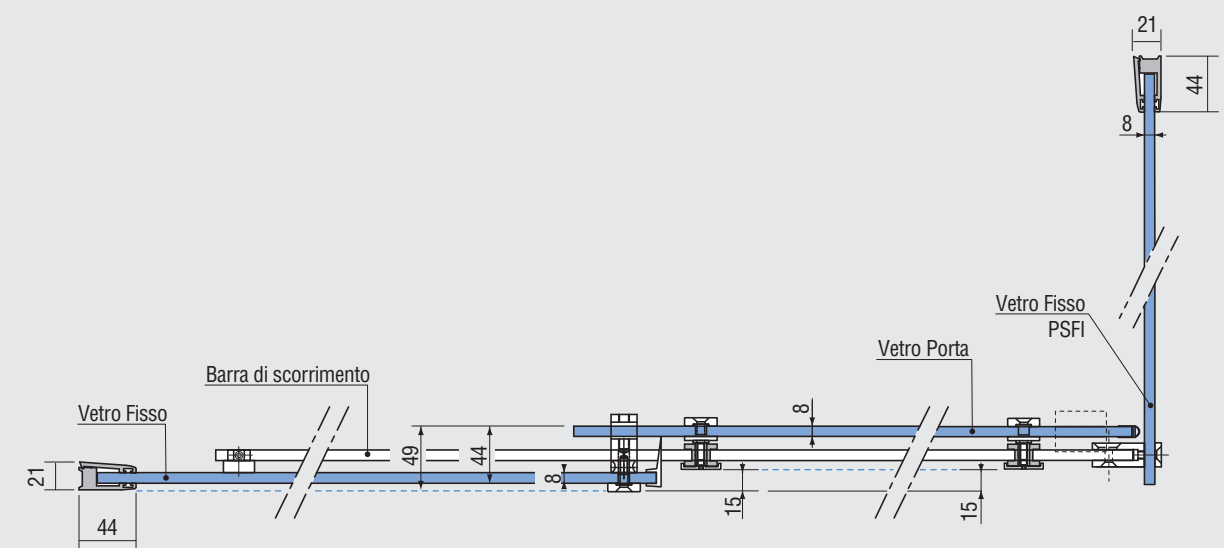

PER UNA CORRETTA
INSTALLAZIONE SERVE UN BORDO
DI ALMENO 45 MM

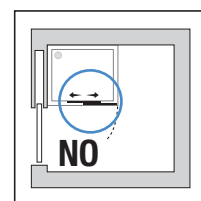

NON È CONSIGLIABILE
POSIZIONARE LA CHIUSURA
DEL BOX IN CORRISPONDENZA
DI PARETE IN CARTONGESSO O
CON PORTA A SCRIGNO